

---

*Comfort-Cire*®

Century®

**MARS**  
Delivering Confidence

---

## PARTS LIST

# Horizontal/Side Discharge Condensing Units

CMA1448SF-1

# EXPLODED VIEW

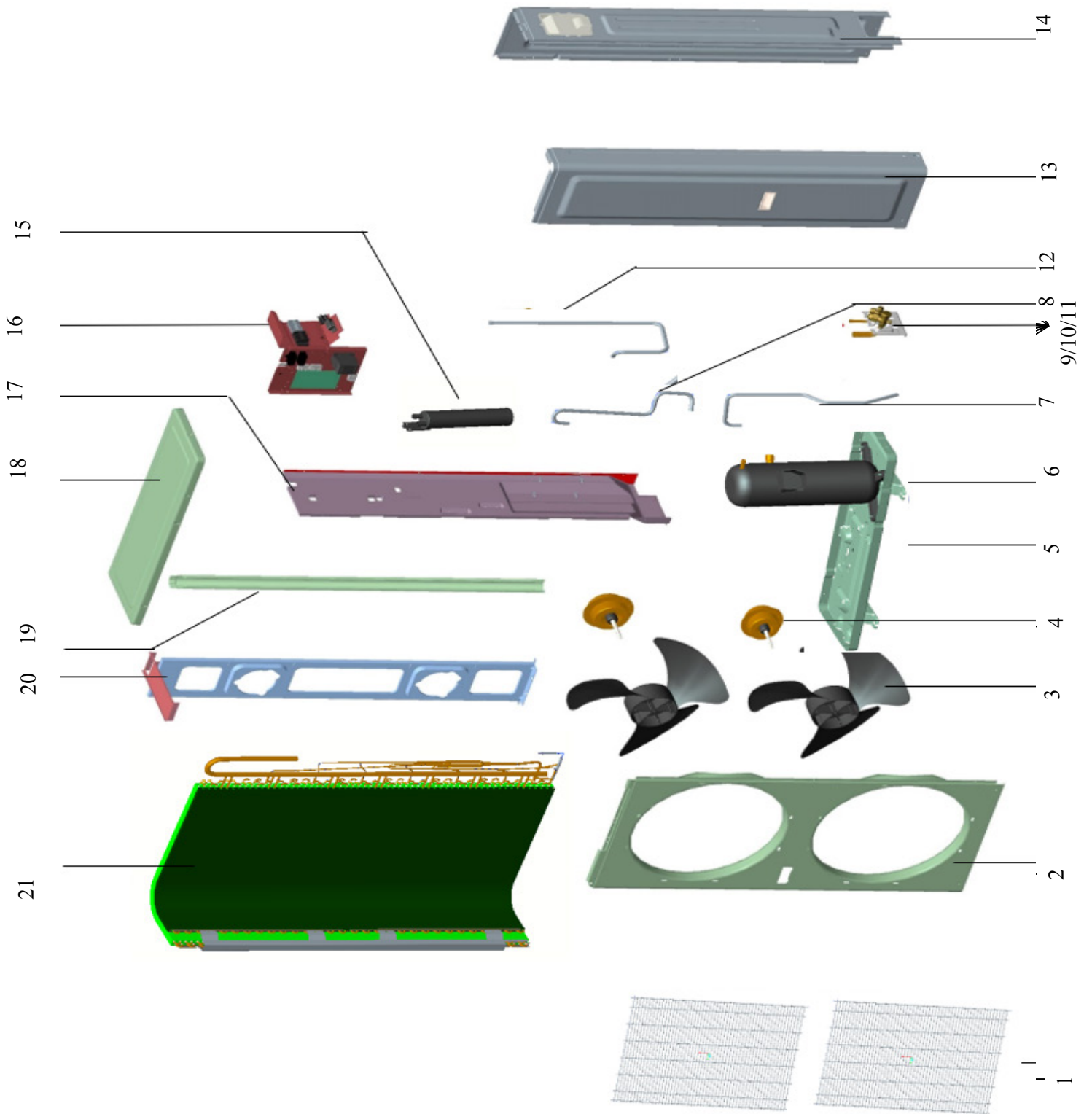

## REPLACEMENT PARTS

Location	Part Name	Quantity	Part No.
1	Top net	2	802933600003
2	Front panel	1	801233600062
3	Propeller fan	2	801133600003
4	DC motor	2	802400300051
5	Chassis welding parts	1	801233600160
6	Compressor	1	801402800019
7	Suction pipe A	1	801634090167
8	Suction pipe B	1	801634090161
9	Valve holder	1	801242000945
10	Cut-off valve DN8 (liquid)	1	801600200013
11	Cut-off valve DN16 (gas)	1	801600200012
12	Discharge pipe	1	801634090162
13	Right clapboard	1	801229200116
14	Rear clapboard	1	801229200117
15	Vapor-liquid seperator	1	801601200037
16	E-parts components	1	803334090030
16.1	Instalation board for E-parts	1	801234090063
16.2	Instalation board for E-parts	1	803300301089
16.3	Contactoer	1	802300100251
16.4	Compressor capacitor	1	802401000046
16.5	wire fastener	1	801102000015
17	Separating board	1	801229200079
18	Cover	1	801233600118
19	Column	1	801233600067
20	Fan motor mounting bracket	1	801234090031
21	Condenser assy	1	801528890021
21.1	Condenser	1	801528890022
21.2	Condensor collecting pipe assy	1	801633490071
21.3	Divider assy for condenser	1	801633490067

---

Due to ongoing product improvements, specifications and dimensions are subject to change and correction without notice or incurring obligations. Determining the application and suitability for use of any product is the responsibility of the installer. Additionally, the installer is responsible for verifying dimensional data on the actual product prior to beginning any installation preparations.

Incentive and rebate programs have precise requirements as to product performance and certification. All products meet applicable regulations in effect on date of manufacture; however, certifications are not necessarily granted for the life of a product. Therefore, it is the responsibility of the applicant to determine whether a specific model qualifies for these incentive/rebate programs.

*Comfort-Aire*®

1900 Wellworth Ave., Jackson, MI 49203 • Ph. 517-787-2100 • [www.marsdelivers.com](http://www.marsdelivers.com)

